

# 140

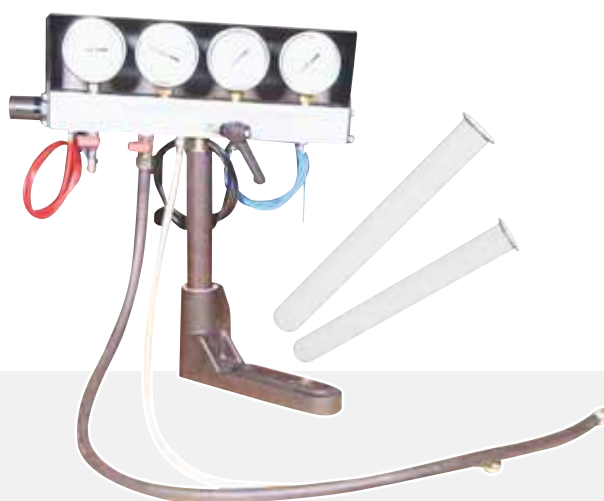

## Test bench spare parts

Basic equipment





## Test bench spare parts

Basic equipment

**140**

### TEST BENCH SPARE PARTS

Graduated test tubes

3 - 4

Auxiliary manometer unit

5

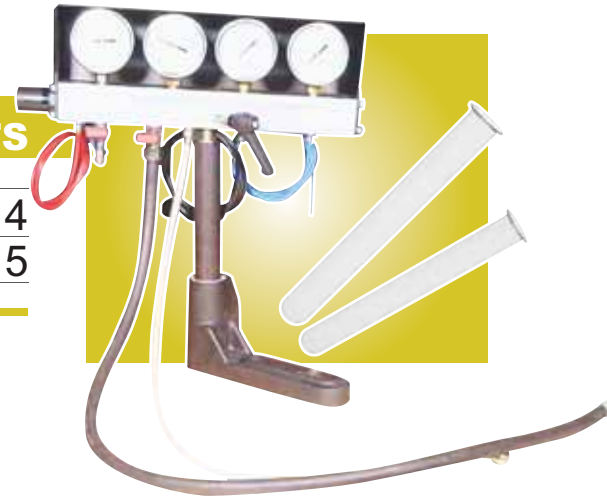

## Conical graduated test tubes

Graduated with mercury at 20°C  
 to assure the maximum accuracy  
*Set of 6, 8, 12 pieces are recommended*

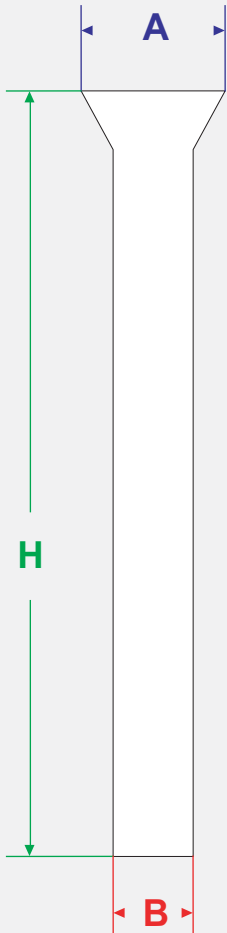

	CODE	CC	B Ø	A Ø	H	APPLICATION
1	<b>80.06.0012</b>	10	11	30,5	217	ODOLINI, RABOTTI
2	<b>80.06.0022</b>	12	11	30,5	217	ODOLINI, RABOTTI MERLIN
3	<b>80.06.0003</b>	12	12	27,5	217	HARTRIDGE
4	<b>80.06.0009</b>	25	15	32	223	ODOLINI
5	<b>80.06.0013</b>	30	17	27	240	ODOLINI, RABOTTI
6	<b>80.06.3003</b>	44	17	36	318	AEGE, ODOLINI BOSCH
7	<b>80.06.0002</b>	45	20	30	217	ODOLINI
8	<b>80.06.0017</b>	50	22	34	220	RABOTTI
9	<b>80.06.0006</b>	50	18	36	292	AEGE, ODOLINI
10	<b>80.06.0008</b>	150	29,5	36	320	BOSCH, DETEQ

## Graduated test tubes

Graduated with mercury at 20°C  
 to assure the maximum accuracy  
*Set of 6, 8, 12 pieces are recommended*

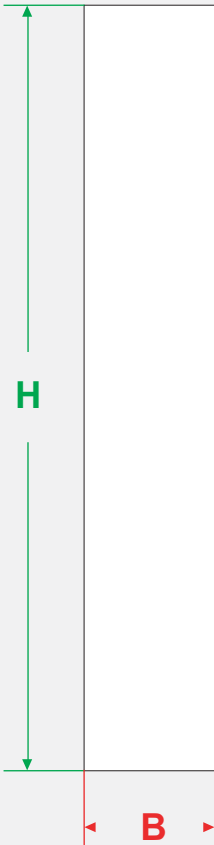

	CODE	CC	B Ø	H	APPLICATION
1	<b>80.06.0010</b>	100	28	222	ODOLINI
2	<b>80.06.0016</b>	130	32,8	218	RABOTTI, AEGE
3	<b>80.06.0018</b> <i>BH 1 680 510 003</i>	150	34	239	BOSCH
4	<b>80.06.0019</b>	200	28	217	RABOTTI
5	<b>80.06.0007</b>	240	36,5	293	ODOLINI, DETEQ
6	<b>80.06.0011</b>	260	37,5	315	--
7	<b>80.01.3004</b>	260	36	318	DETEQ
8	<b>80.06.0015</b> <i>BH 1 680 439 506</i>	260	37	320	BOSCH
9	<b>80.06.0023</b>	270	38	292	AEGE



**MARBED**<sup>®</sup>  
PROFESSIONAL DIESEL SERVICE TOOLS

# 9632-A

## Auxiliary manometer unit

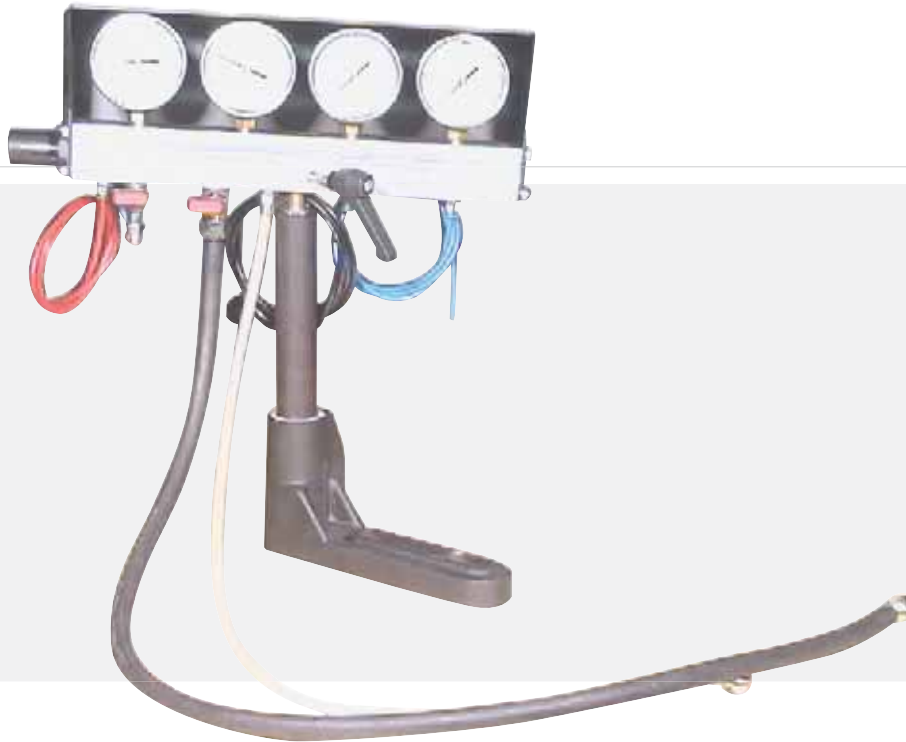

**9632-A**

1 688 130 075

Auxiliary manometer unit to test rotary pumps on test bench,  
equipped with:

*0-1,6 BAR manometer and correspondent  
pressure regulator to test LDA devices*

*-1/0/+3 BAR combined vacuum manometer to check  
the pump feed pressure and allow the vacuum tests*

*0-16 BAR manometer to check the transfer pressure*

*0-2,5 BAR manometer to check the pump box pressure*

*Pipes and fittings*

### manometers

**8140**

0-1,6 BAR gliceroil manometer

**8139**

-1/0/+3 BAR gliceroil combined manometer and vacuum meter

**9286**

0-16 BAR gliceroil manometer for transfer pressure  
Ø 63 - 3/8 GAS

**9287**

0-1 BAR gliceroil manometer for inlet pressure  
Ø 63 - 3/8 GAS

**9288**

0-2,5 BAR gliceroil manometer for pressure charge  
Ø 63 - 3/8 GAS

**9302**

-760/0 mmHg -1/0 BAR gliceroil vacuum meter

## **MARBED BOOK 2011**

©2011 MARBED S.r.l. - Italy

This catalog is, to all intents, protected by copyright, so the reproduction in part or in full of photos, drawings, etc.. is prohibited.

Original part numbers listed in this catalog are given for reference.

The data and information, shown in this technical catalog, replace the previous edition that is now obsolete.

All specifications, dimensions, weights in this catalog are subject to change without notice.

The illustrations are not binding.



[www.marbed.com](http://www.marbed.com)

MARBED Srl - Piazza Novelli, 4 - 20129 Milano - Italy

Tel. +39 02.71.49.84 - Fax +39 02.70.10.26.67

e-mail [info@marbed.com](mailto:info@marbed.com)